

# PEARL

Retirement Resort

11 Waratah Crescent  
Fannie Bay

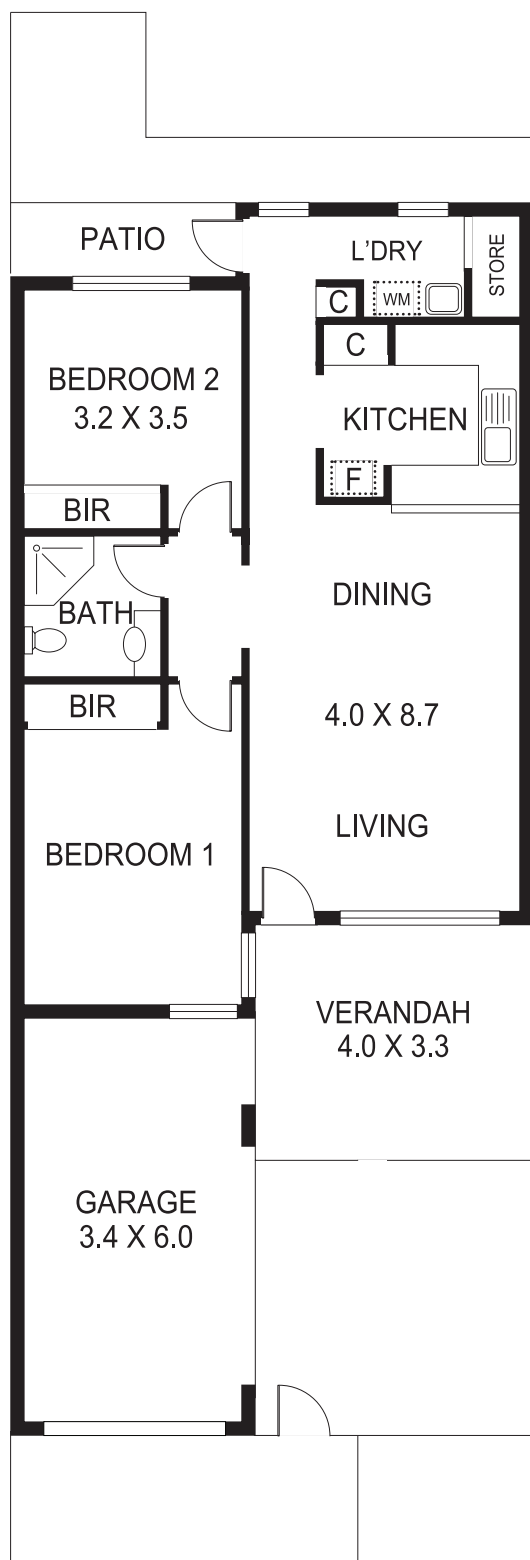

## Terrace Villa 51

2 | 1 | 1

### Specifications

Living Area

109.37 m<sup>2</sup> / 11.77sq

Garage / Outdoor

65.5 m<sup>2</sup> / 7.05sq

Total Living

174.87m<sup>2</sup> / 18.82sq

1800 894 375

[southerncrosscare.com.au](http://southerncrosscare.com.au)

Specifications and details are indicative only and are subject to change

Southern Cross Care (SA & NT) Inc. ARBN 129 895 905, South Australia, liability limited.  
Correct as at June 2019

Better  
for life

